

CaviWipes™ Bleach

If gross debris is present on the surface:

1. Pull out CaviWipes Bleach towellette, tearing at a 90° angle.

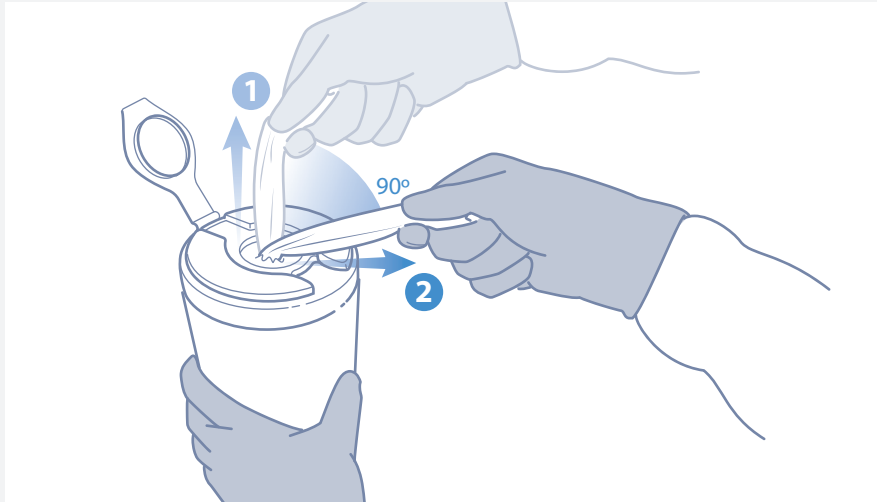

2. Use CaviWipes Bleach towelette(s) to completely pre-clean surface of all gross debris. Once surface is clean, dispose of used towelette in accordance with Federal, State, and local regulations for infectious materials disposal.

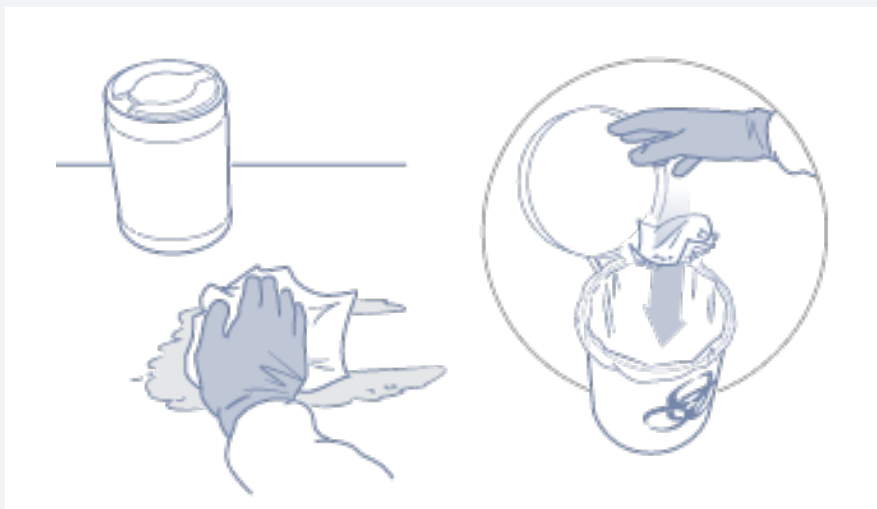

Disinfect after Cleaning

3. Pull out additional towelette.
4. Disinfect pre-cleaned surface with towelette. Leave surface wet for 3 minutes. Dispose of used towelette.



If NO gross debris is present on the surface:

1. Pull out CaviWipes Bleach towellette, tearing at a 90° angle.



2. Disinfect surface with towelette. Leave surface wet for 3 minutes. Dispose of used towelette in accordance with Federal, State, and local regulations for infectious materials disposal.

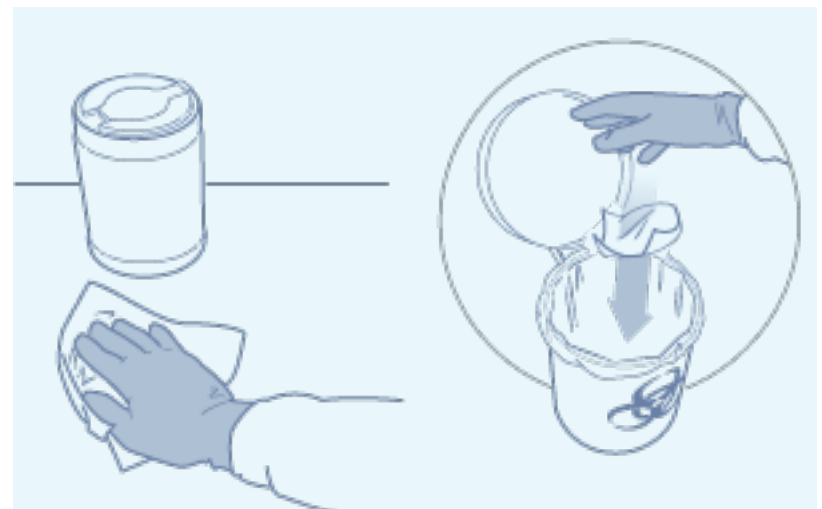

Ordering Information

Part No. US/CAN	Description	Packaging
13-9100 / 11-1200	CaviWipes Bleach, 6" x 10.5" (90 wipes per canister)	12 canisters / case
13-1175	CaviWipes canister wall bracket	12 brackets / case
13-1185	Flat Pack Wall Mount	20 mounts / case



Distributed By:

NEWCOMER SUPPLY
Your Histology Supplier

2505 Parview Road, Middleton, WI 53562 (800) 383 • 7799 (608) 831 • 7888 FAX (608) 831 • 0866 • www.newcomersupply.com

MKT-19-0203 ©2019 Metrex Research